

Screw Collar Loop #60236

What's Inside

1 – 1/4 IP Screw Collar Loop – Brass Finish

What's Its Purpose

Decorative loop that secures 1 1/16" center hole canopy

Warning

- Before beginning **TURN OFF POWER** to the light from the fuse or circuit breaker.
- Follow local electrical regulations or codes when installing and using this product.
- Outlet box must be capable of holding up to 50 lbs.

What's Needed

1 1/16" Center Hole Canopy

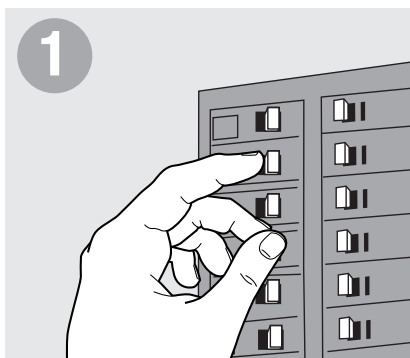

Before beginning **TURN OFF POWER** to light from fuse or circuit breaker.



Check fit, cover outlet box with canopy and secure with screw collar loop. If needed, adjust nipple so canopy rests against ceiling after installation. Remove.

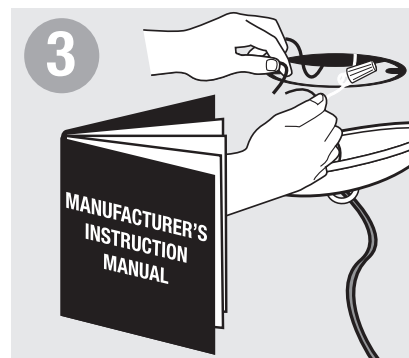

Securely Install fixture following manufacturer's recommended instructions.



Cover with canopy and secure with screw collar loop.